



# MTS

## Manual Transfer Switch

User-friendly Installation | Safe Changeover

### MANUALLY CONTROL YOUR POWER SOURCE

Elmeasure Manual Transfer Switch (MTS) is designed to provide smooth and safe transmission of load from one power source to another and back again. MTS is reliable, safe and is operated with a single handle manually to ensure supply continuity

#### Features:

- MTS has a 3 position switch I-O-II
- Conformity to IS/IEC 60947-3
- Utilization category AC 23
- Robust and easy-to-use
- Modular and compact design
- Designed to withstand high thermal conditions
- Wide range from 63 to 630A
- Operating handle with provision to lock in ON/OFF position
- User-friendly installation and operation
- Quick-make & quick-break operation for transferring of loads
- Tolerance to high electrical and mechanical characteristic
- Incoming and outgoing terminal interchangeability
- Terminals suitable for aluminum and copper conductor Connectivity.

#### Benefits:

- The safest changeover during the failure of a primary source
- High short-circuit withstand capacity
- facilitate easy installation and simplified wiring connections
- Reliable and maintenance free operation.
- Reduce installation time and cost.
- High electrical and mechanical life
- Customized Incoming and Outgoing Terminal interchangeability
- Terminal shrouds and phase barriers provides complete safety
- Rugged design to compact environmental conditions

#### Application:

- Generator OEM's
- Commercial buildings
- Automobile Industry
- Manufacturing Industry
- Power distribution and Load Management

## Mechanical Specification (mm)

### 63 - 100A

#### Direct front operation

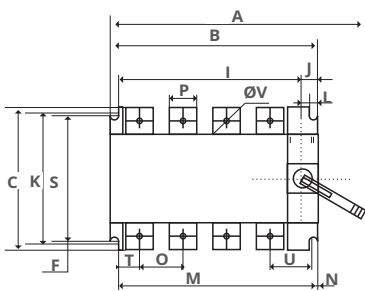

#### External front operation

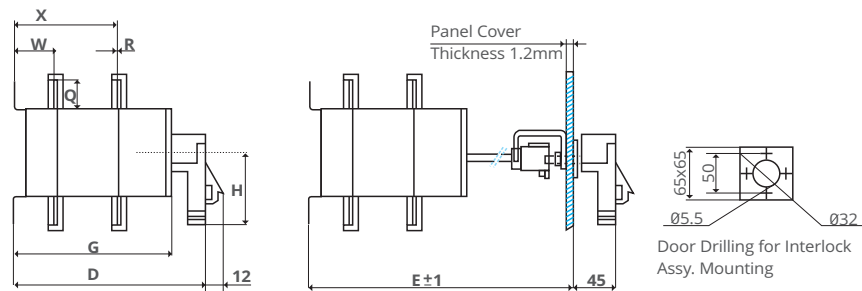

Rating(A)	Dimensions										Fixing of Sw.					Connection terminal						Sw. Wt.			
	A	B	C	D	E	F	G	H	I	J	K	L	M	N	O	P	Q	R	S	T	U	ØV	W	X	Open Ex. (kg)
4 x 63	181	141.5	111	168.5	192	44	127	62	116	18	95	6.5	127	6.25	27	14	16	2.6	91	11	35	6.5	45	101	2
4 x 100	181	141.5	111	168.5	192	44	127	62	116	18	95	6.5	127	6.25	27	14	16	2.6	91	11	35	6.5	45	101	2

# 125 - 630A

## Direct front operation

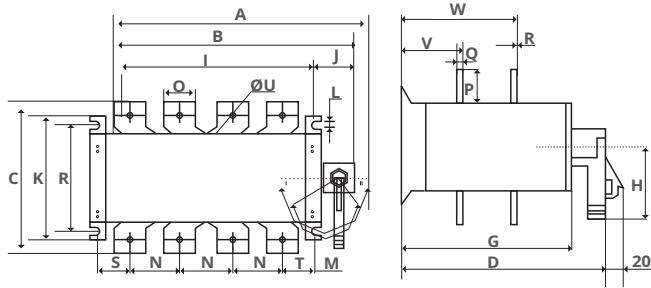

## External front operation

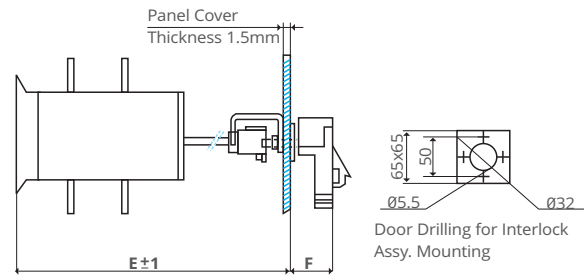

Rating(A)	Overall Dimensions										Fixing of Sw.				Connection terminal								Sw. Wt. Open Ex. (kg)	
	A	B	C	D	E	F	G	H	I	J	K	L	M	N	O	P	Q	R	S	T	ØU	V		W
4 x 125	305	227	142	216	232	65	151	115	159	58	95	7.0	26	45	22	28	3.0	118	12	12	8.5	54	120	4.0
4 x 160	305	227	142	216	232	65	151	115	159	58	95	7.0	26	48	25	35	4.0	123	7	7	10.5	54	120	5.0
4 x 200	305	227	142	216	232	65	151	115	159	58	95	7.0	26	48	25	35	4.0	123	7	7	10.5	54	120	5.0
4 x 250	363	285	192	238	249	65	168	127	212	63	111	7.5	27	64	32	46	4.5	152	7	13	12	62	140	7.3
4 x 320	363	285	192	238	249	65	168	127	212	63	111	7.5	27	64	32	46	4.5	152	7	13	12	62	140	7.3
4 x 400	458	360	235	307	320	65	242	140	271	80	180	9.0	45	73	40	40	5.0	205	26	26	11	84	195	14.0
4 x 630	458	360	270	307	320	65	242	140	271	80	180	9.0	45	81	55	55	5.0	230	14	14	14.5	84	195	17.0

## Technical Specification:

	MTS 63A-4P	MTS 100A-4P	MTS 125A-4P	MTS 160A-4P	MTS 200A-4P	MTS 250A-4P	MTS 320A-4P	MTS 400A-4P	MTS 630A-4P
<b>GENERAL CHARACTERISTICS</b>									
<b>Thermal current I<sub>th</sub> (40°C)</b>	<b>63 A</b>	<b>100 A</b>	<b>125 A</b>	<b>160 A</b>	<b>200 A</b>	<b>250 A</b>	<b>320 A</b>	<b>400 A</b>	<b>630 A</b>
Max. Normal rating of fuses	63	100	125	160	200	250	315	400	630
Insulation voltage U <sub>i</sub> (V)	750	750	750	750	1000	1000	1000	1000	1000
Dielectric strength (V) 50 Hz 1 mm.	4000	4000	5000	5000	5000	5000	5000	8000	8000
Impulse voltage (kV)	6	6	6	6	8	8	8	12	12
<b>Rated operational currents I<sub>e</sub> (A)</b>									
415 VAC-AC 23A	63	100	125	160	200	250	320	400	630
500 VAC-AC 23A	55	55	100	130	160	200	250	315	315
440 VDC-DC 21A	63	100	125	160	200	250	320	400	500
440 VDC-DC 22A	63	100	125	130	160	200	250	400	500
440 VDC-DC 23A	63	63	125	130	160	200	250	400	500
<b>Protection</b>									
Short-circuit current with fuses (kA rms)	80	80	80	80	80	80	80	80	80
Fuse rating	63	100	125	160	200	250	315	400	630
Peak short-circuit making capacity (kA rms)	15	15	20	20	20	30	45	45	45
Admissible short time current 1 sec (kA rms)	5	5	7	7	7	9	13	13	13
<b>Making &amp; Breaking Characteristics</b>									
Breaking Capacity (Arms)									
415 VAC pf-0.35	504	504	1000	1280	1600	2000	2520	3200	5040
Making Capacity (Arms)									
415 VAC pf-0.35	630	630	1250	1600	2000	2500	3150	4000	6300
<b>Endurance</b>									
Mechanical No. of Operations	10000	10000	8000	8000	8000	8000	5000	5000	5000
Electrical No. of Operations	2500	1500	1000	1000	1000	1000	1000	1000	1000
Operating Force (Nm)	3.5	3.5	9.5	9.5	9.5	11	11	17	17
<b>Connection</b>									
Min. Cu Cable / Bus bar size (mm <sup>2</sup> )	16	35	50	70	95	120	185	240	40 x 5 x 2
Min. Al Cable / Bus bar size (mm <sup>2</sup> )	25	2 x 25	70	95	150	185	240	300	40 x 8 x 2



**ELMEASURE**<sup>®</sup>  
Possibilities...Infinite

### HEAD OFFICE:

PLOT NO.: 47-P, HARDWARE PARK, KIADB, HUVINAYAKANAHALLI, JALA HOBLI, YELAHANKA TALUK, BENGALURU - 562 149. KARNATAKA INDIA

✉ info@elmeasure.com

☎ Toll Free: 1800 120 5048

🌐 elmeasure.com